

Know Your Exit

Typical tenant floor:

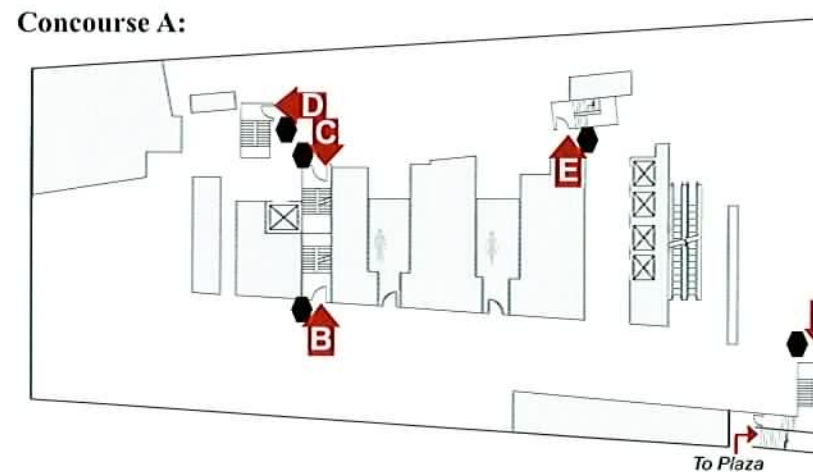
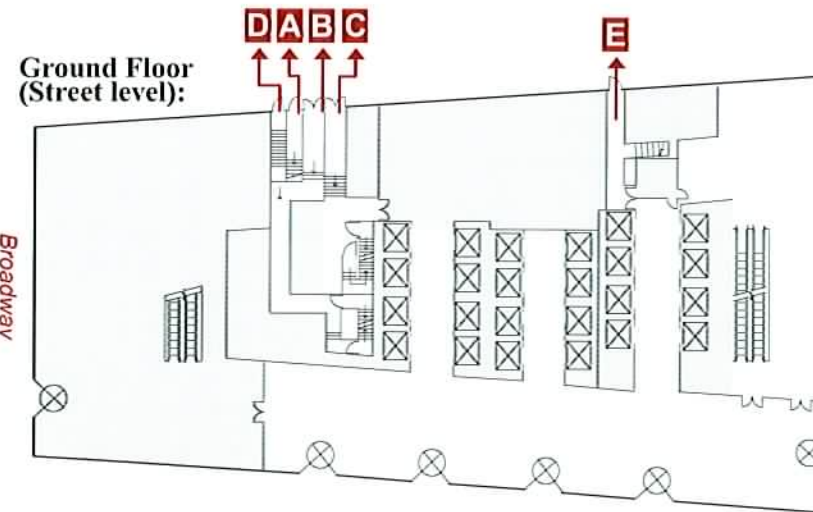
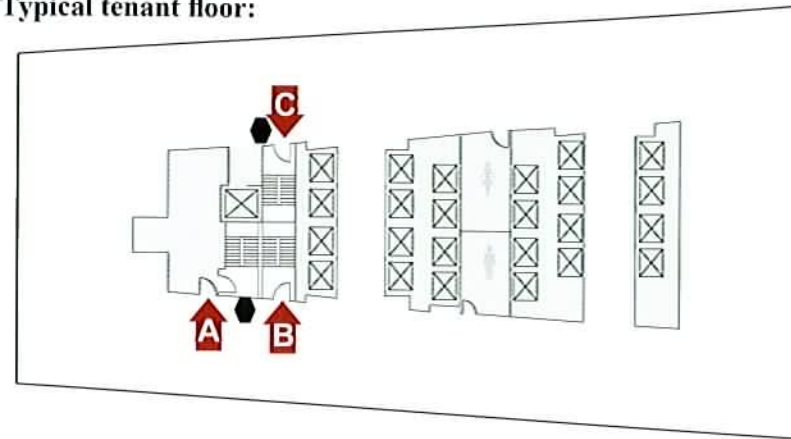

A Exit stairwell **A** Stairwell termination ● Manual pull station

A SAFE ENVIRONMENT

140 Broadway was designed to minimize the chance of a life-threatening emergency, and to reduce damage in the event one does occur.

All alarms received from smoke detectors, sprinkler systems and manual pull stations cause an immediate localized response, and send a signal when warranted to the fire department. These devices also shut down air handling equipment to prevent the spread of smoke and fire. At the same time, elevators are returned automatically to the main lobby to await fire-fighters, and stairwell doors on re-entry floors only are unlocked electrically to facilitate relocation. All building mechanical and communications systems can be controlled from the Fire Command Station in the main lobby.

Due to the fire-resistant qualities of modern office high-rises, relocation is usually necessary only from the floor in alarm and the floor directly above, and alarms will ordinarily sound only on these floors. There is very little chance of a fire spreading in 140 Broadway, but it is essential that you be ready to do your part by becoming familiar with exit stairwells, manual pull stations, and fire extinguishers. Extinguishers are located within the B and C stairwells on each floor in addition to those located within tenant spaces. It is also very important that you participate in the fire drills that are conducted.

IN CASE OF EMERGENCY

Stay calm and help others. Listen for instructions. If smoke or fire is present, relocate at least two floors down.

My nearest exit: _____

My alternate exit: _____

My fire warden: _____

New York City Fire Dept.	911
New York City Police Dept.	911
Medical Emergency	911
Bomb Squad	911
Building Management Office	(212) 943-1500